



Read-Only-Mode (ROM) Memory Solutions

Enhancing Data Security and Privacy



Read-Only-Mode Memory Card

Ensure the authenticity of stored data



Keeps the Data Unalterable

Keep your crucial data in a tamper-proof storage solution with Flexon Read-Only Mode Memory Card. It is highly effective to ensure the utmost data security in a memory device. ~~Once you activate the Read Only mode on the memory card, all the stored data is enabled for reading only. No one can change, delete, or overwrite anything, so you can preserve the authenticity of the essential files in the memory card.~~

Introduction



Purpose

- ❖ To provide an introduction to Flexxon Read-Only Mode (ROM) Memory Card.

Objective

- ❖ Give an overview of the product and features.
- ❖ Provide the operation flow and user guide.
- ❖ Provide application examples.



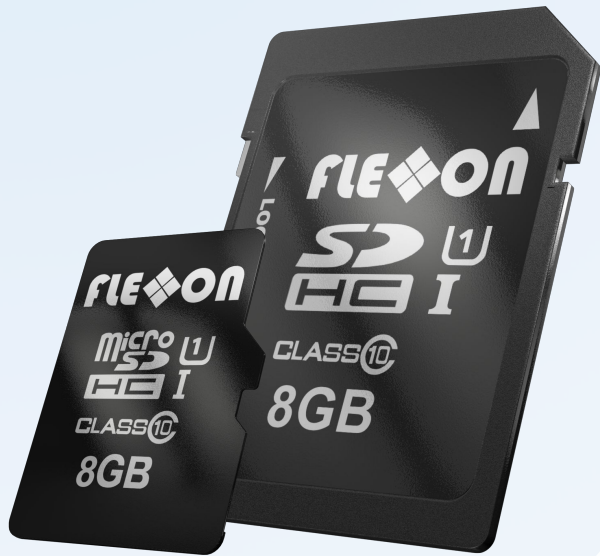

Secured Data

- ❖ Read-only Mode prohibit data from the risk of alteration.



Security Mechanism

- ❖ Use security tool (Windows / Linux) and password to activate and deactivate read only mode.



Password Encryption

- ❖ Using data scrambling and hash algorithms.

- ❖ SD 3.0 Compliant
- ❖ Capacity
 - microSD: 4GB – 128GB
 - SD: 4GB – 256GB
- ❖ Auto Read Refreshment
- ❖ Read disturbance management
- ❖ Adaptive wear levelling
- ❖ Power Loss Protection
- ❖ SMART tool
- ❖ Temperature Range
 - Operation (Gold): -25C ~ 85C
 - Operation (Diamond): -40C ~ 85C
 - Storage: -40C ~ 85C

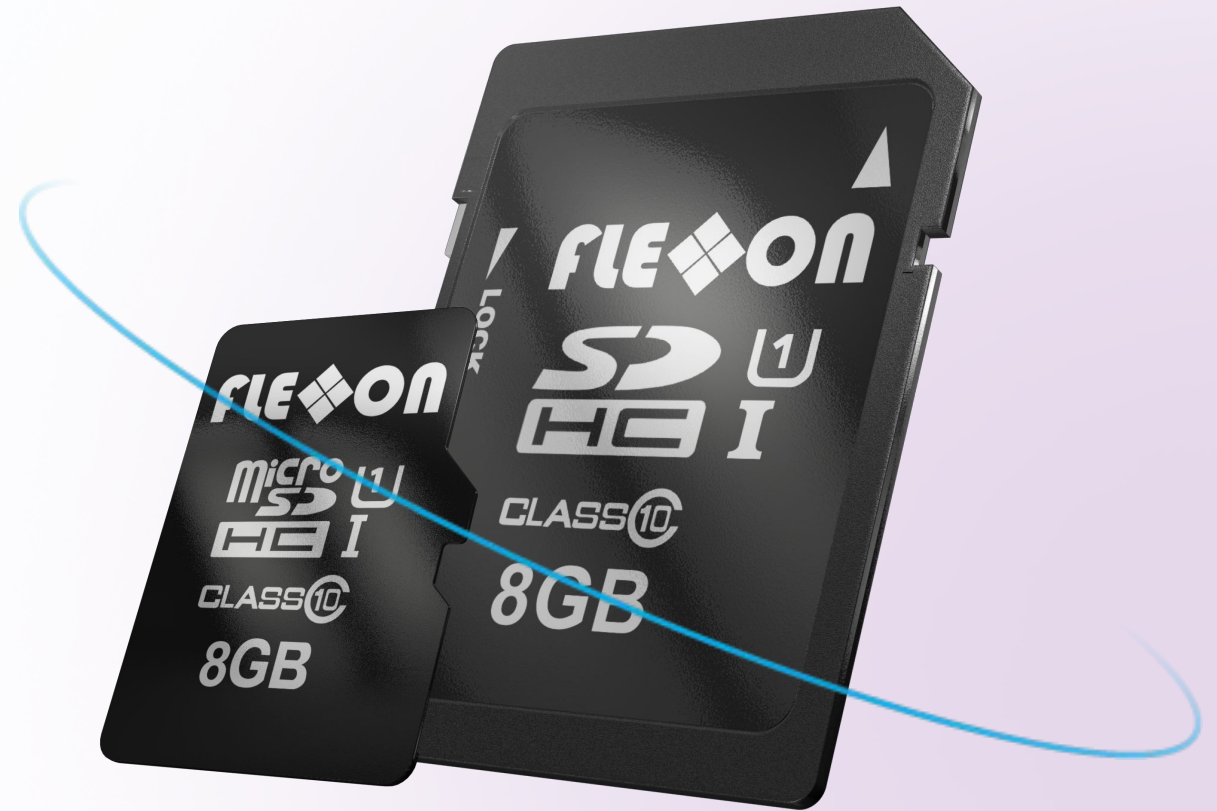

- a. ROM card is normal mode by default.
- b. Windows Tool allows the user to set password to activate/deactivate ROM mode.
- c. 3 Steps are required to use the ROM card.

Step 1:

Install the Software

You need to install a software tool to enable or disable the Read-Only mode.

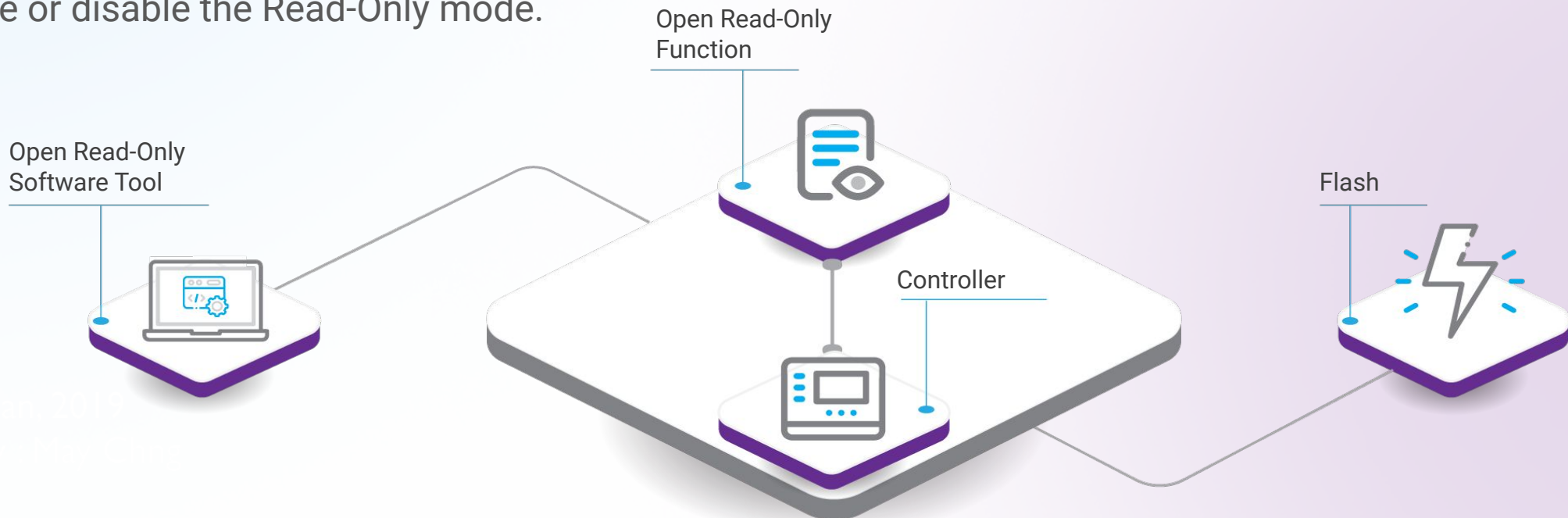

Date: 17 Jan 2019

Prepared By: [Name]

Step 2:

Enable the Read-Only Function

Enable the Read-Only Mode from the software following the chart step by step.

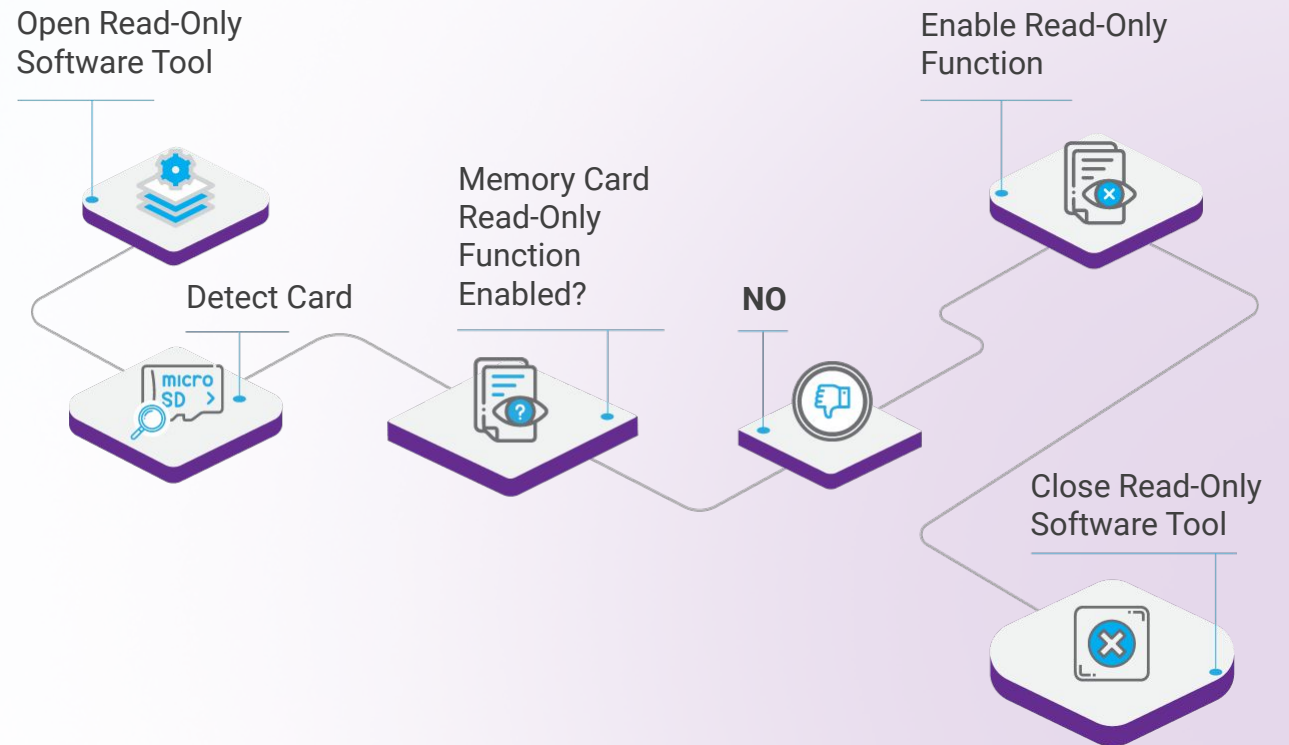

Step 3:

Disable the Read-Only Function

To change the data, disable the Read-Only Mode from the software first, make certain edits, and enable to keep data security intact.

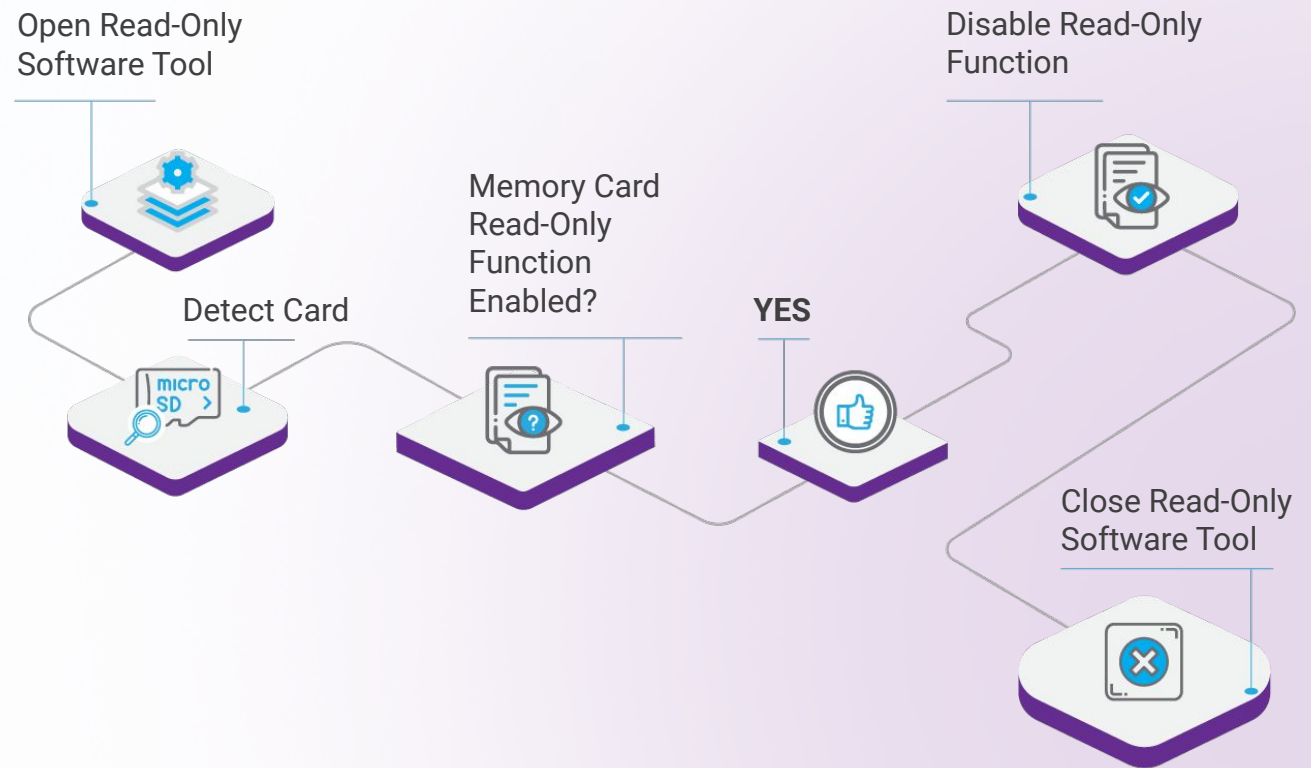

Step 1: Launch Flexxon Tool

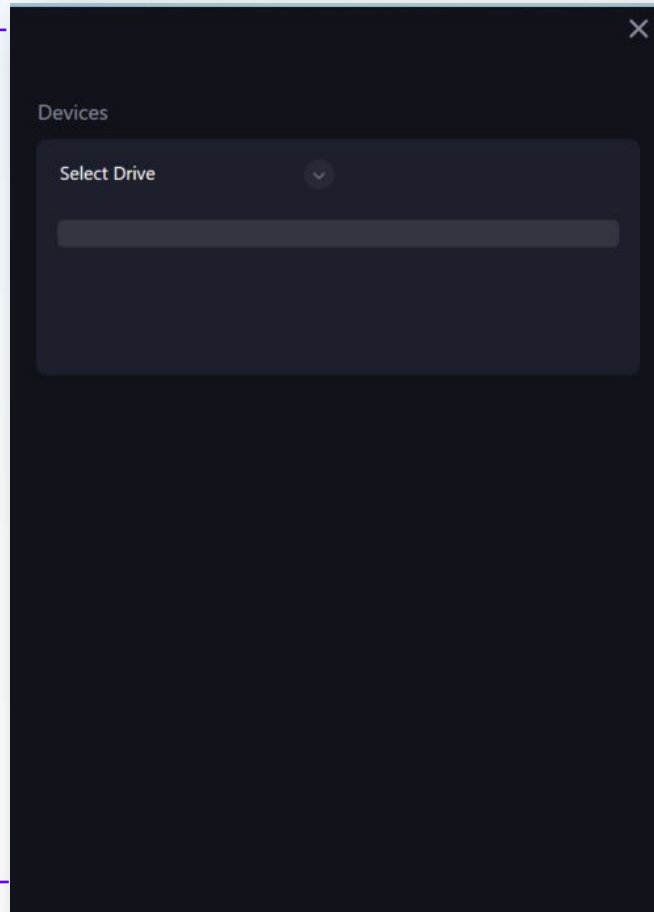
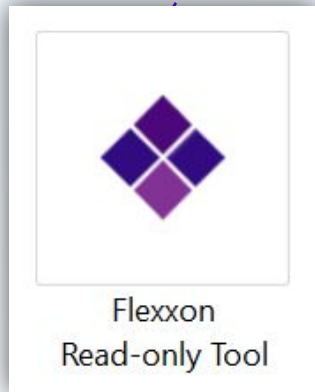

Step 2: Upon inserting the ROM Memory Card, the ROM Tool will automatically recognize the connected Memory Card.

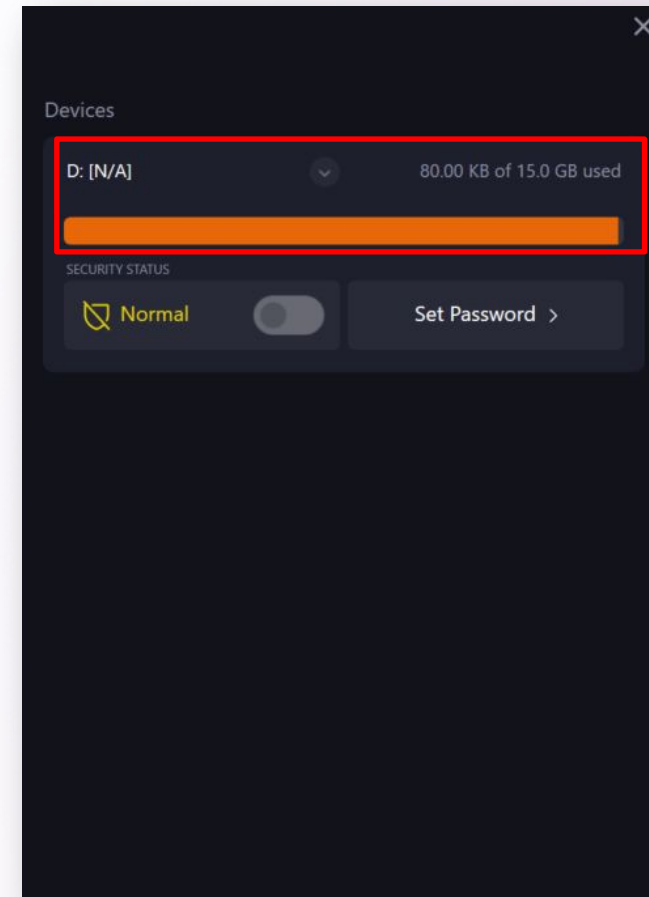

Step 3:

When the ROM Windows Tool displays the '**Normal**' status, it indicates that no password has been set for this Memory Card.

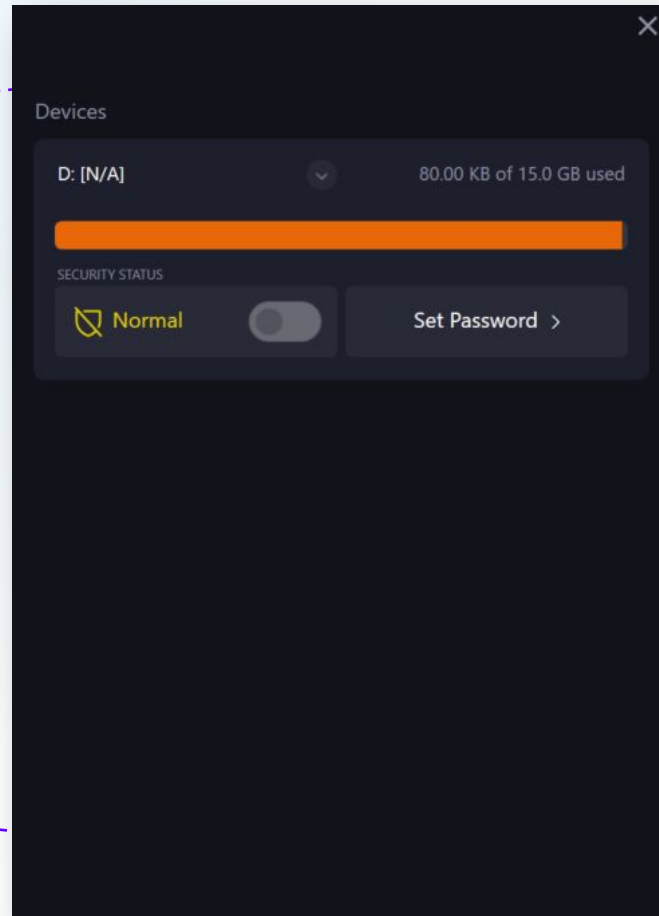

Step 4:

To set a password, click on "**Set Password**" and enter your chosen password.

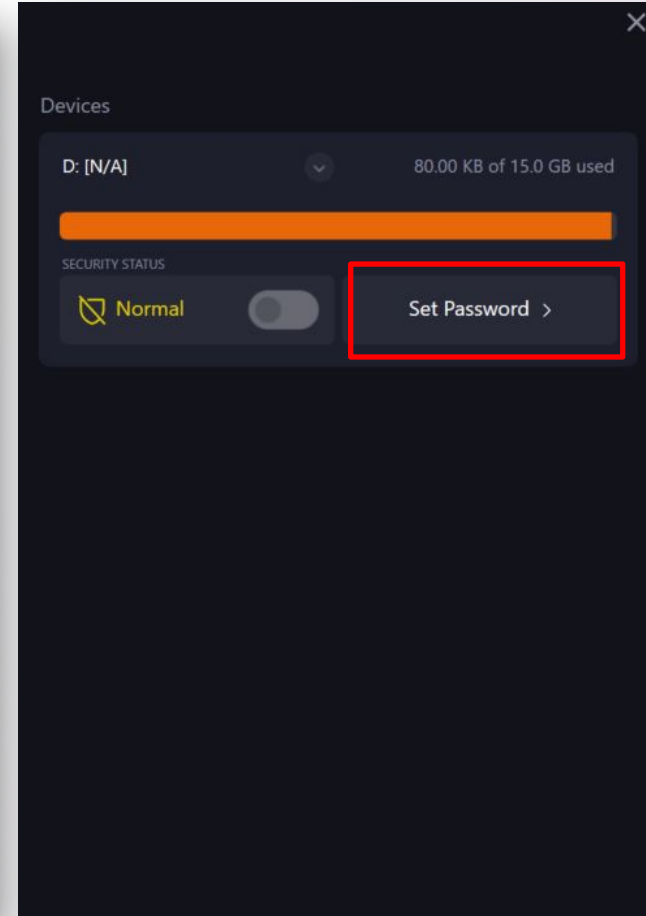

Step 5: Once you have successfully configured the Memory Card, disconnect and then reconnect the ROM Memory Card.

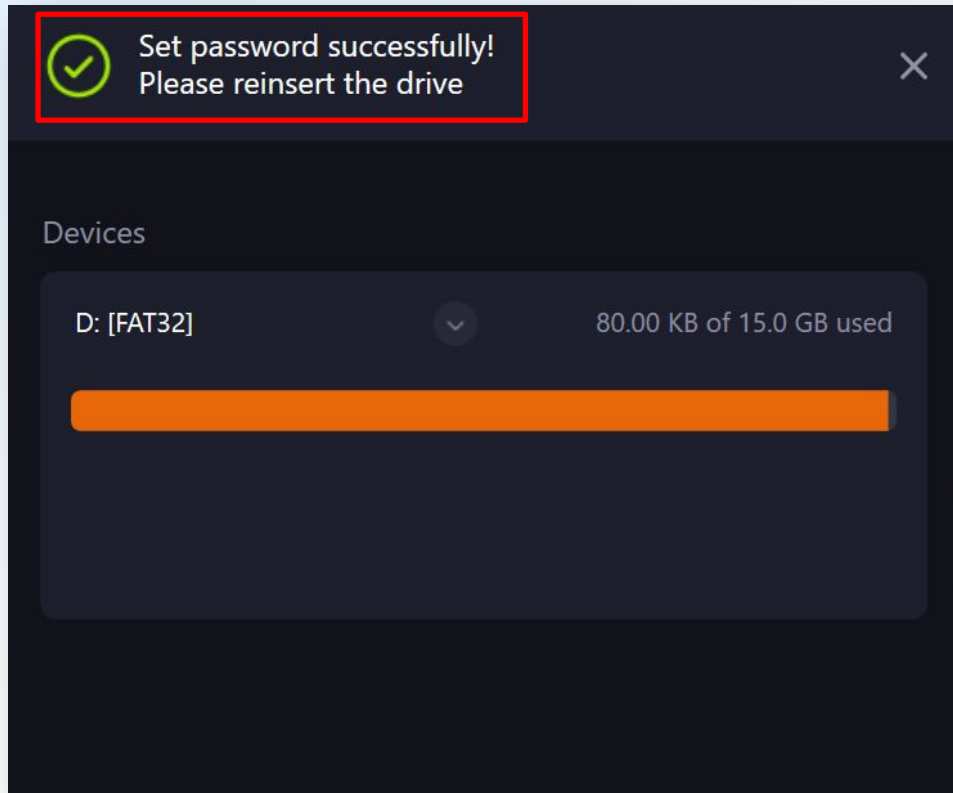

Step 6: After reinserting the ROM Memory Card, the read only mode is activated. All the stored data enables access for reading only. None can change, delete, or overwrite anything from the stored data. So, you can preserve the authenticity of the essential files into the Memory Card and prohibit it from the risk of alteration.

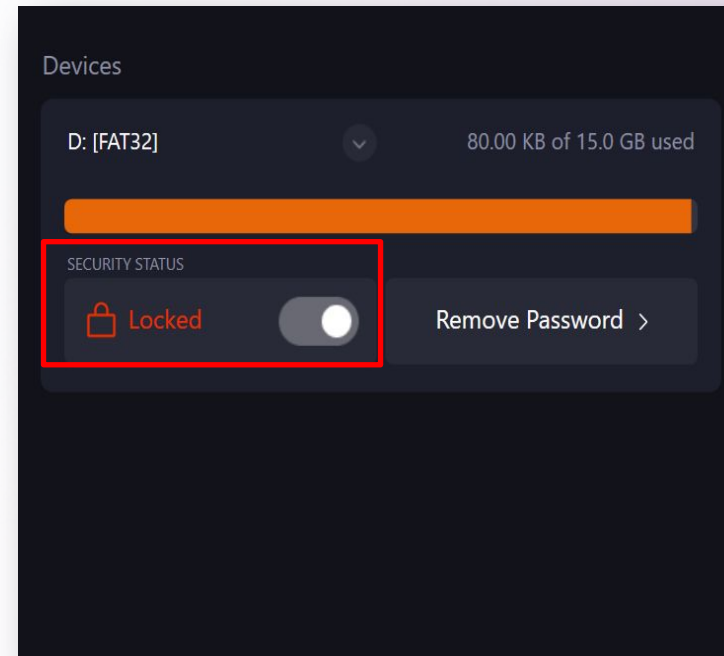

Note: User is required to eject and insert ROM Memory Card to verify the content in ROM Memory Card.

The drive is in 'ROM' status, and the ROM Tool shows 'Locked'.

Step 7:

Functionality for 'Locked' button

The administrator can use the Flexxon ROM Tool and the Correct Password to temporarily modify data. However, once the Memory Card is disconnected from the host, it retains the ROM state.

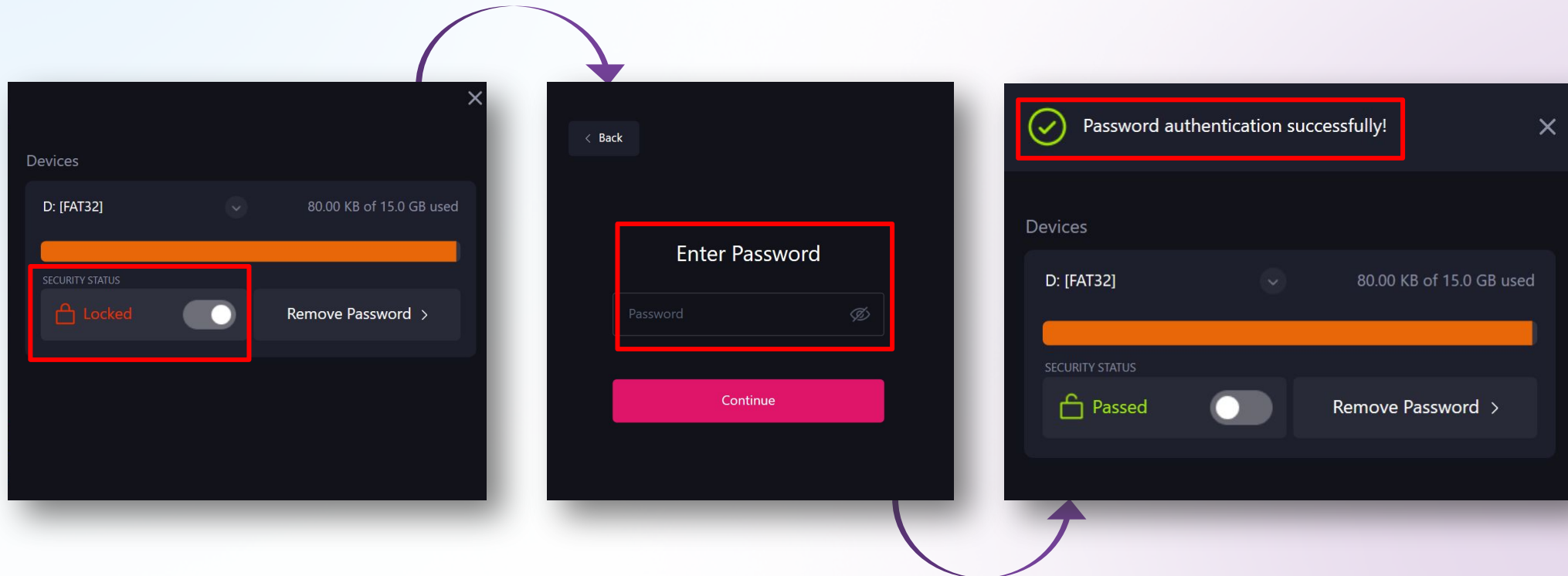

Note: The Memory Card return to Read Mode after reinsert the drive.

To Remove Masking Feature

Select "Remove Password" and enter the **correct password**. Once the password is removed, a prompt will indicate "**Normal Status and No Password Exist.**" The ROM Memory Card will then operate like a standard Memory Card without the Read-Only feature.

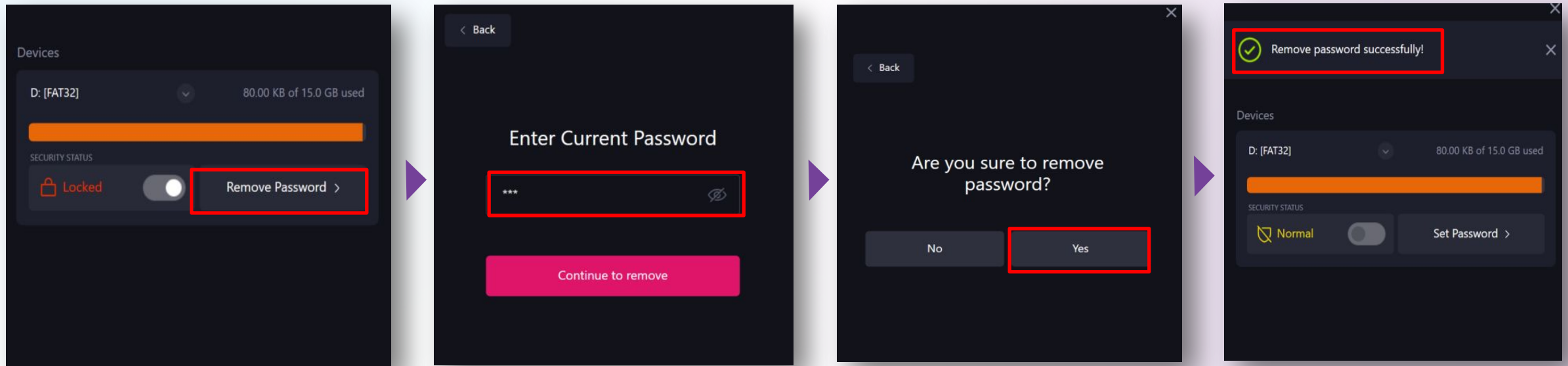

Applications | ROM Memory card



Medical And Healthcare Facilities:
Keep the sensitive patient reports maintaining confidentiality and integrity.



Cybersecurity Industry
Protect all the information in the Electronic system from threats of illegal activities.

Financial Institutes:
Secure influential financial Records and refrain from a financial data breach.

Business Organizations:
Keep important business documents in an unalterable memory solution.



Read Only Mode (ROM) USB Pen Drive

Futuristic digital slant towards
a flexible data storage solution



A Top-Grade Pliable Storage Alternative

The Read Only USB is a flexible, intelligent, robust, high speed and multi-purpose device that can enable or disable its state-of-the-art feature of Read-only mode to prohibit or permit modifications. The Read Only USB authorizes its security function as a defense mechanism to ensure the integrity of sensitive data by extending **hardware-based encrypted access**.

Introduction



Purpose:

- ❖ To provide an introduction to Flexxon Read Only Mode (ROM) USB Drive.

Objective:

- ❖ Give an overview of the product and features.
- ❖ Provide the operation flow and user guide.
- ❖ Provide application examples.





Secured Data

- ❖ Read-only Mode prohibit data from the risk of alteration.



Security Mechanism

- ❖ Use security tool (Windows / Linux) and password to activate and deactivate read only mode.



Password Encryption

- ❖ Using data scrambling and hash algorithms.

- ❖ USB 2.0 Compliant
- ❖ Capacity
 - 8GB – 32GB
- ❖ Auto Read Refreshment
- ❖ Read disturbance management
- ❖ Adaptive wear levelling
- ❖ Power Loss Protection
- ❖ Temperature Range
 - Operation (Diamond): -40C ~ 85C
 - Storage: -40C ~ 85C



- a. ROM USB Drive is normal mode by default
- b. Windows Tool allows user to set password to activate/deactivate ROM mode.
- c. 3 Steps is required to use the ROM USB Drive.

Step 1:

Install the Software

You need to install a software tool to enable or disable the Read-Only mode.

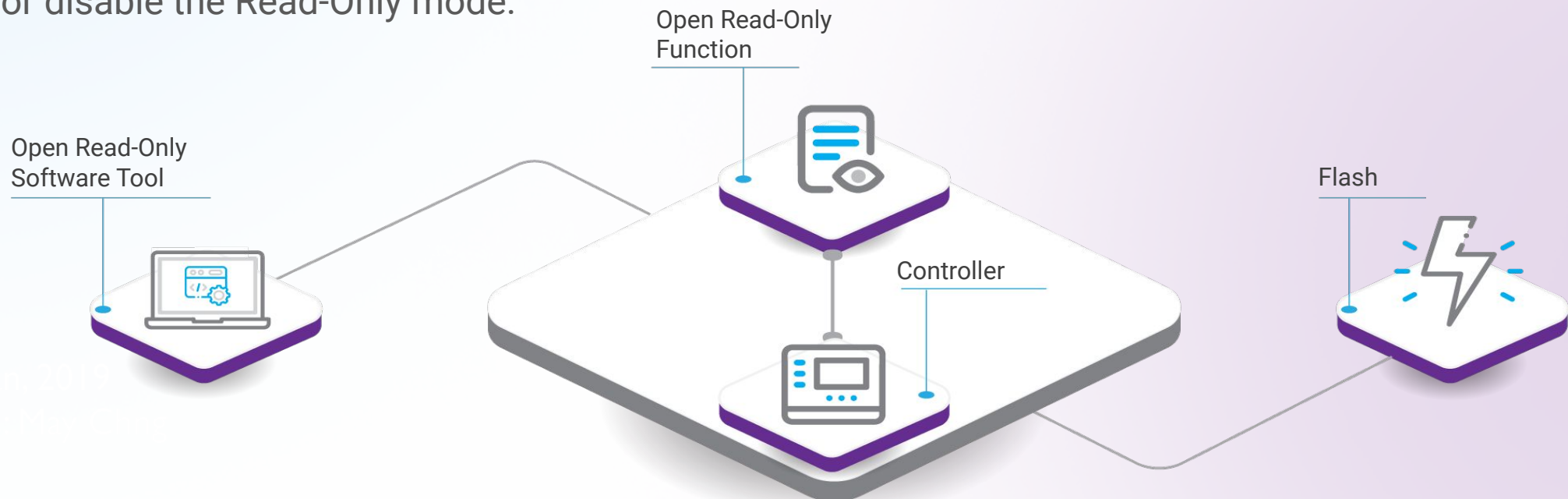

Date: 17 Jan 2019

Present By: [Name]

Step 2:

Enable the Read-Only Function

Enable the Read-Only Mode from the software following the chart step by step.

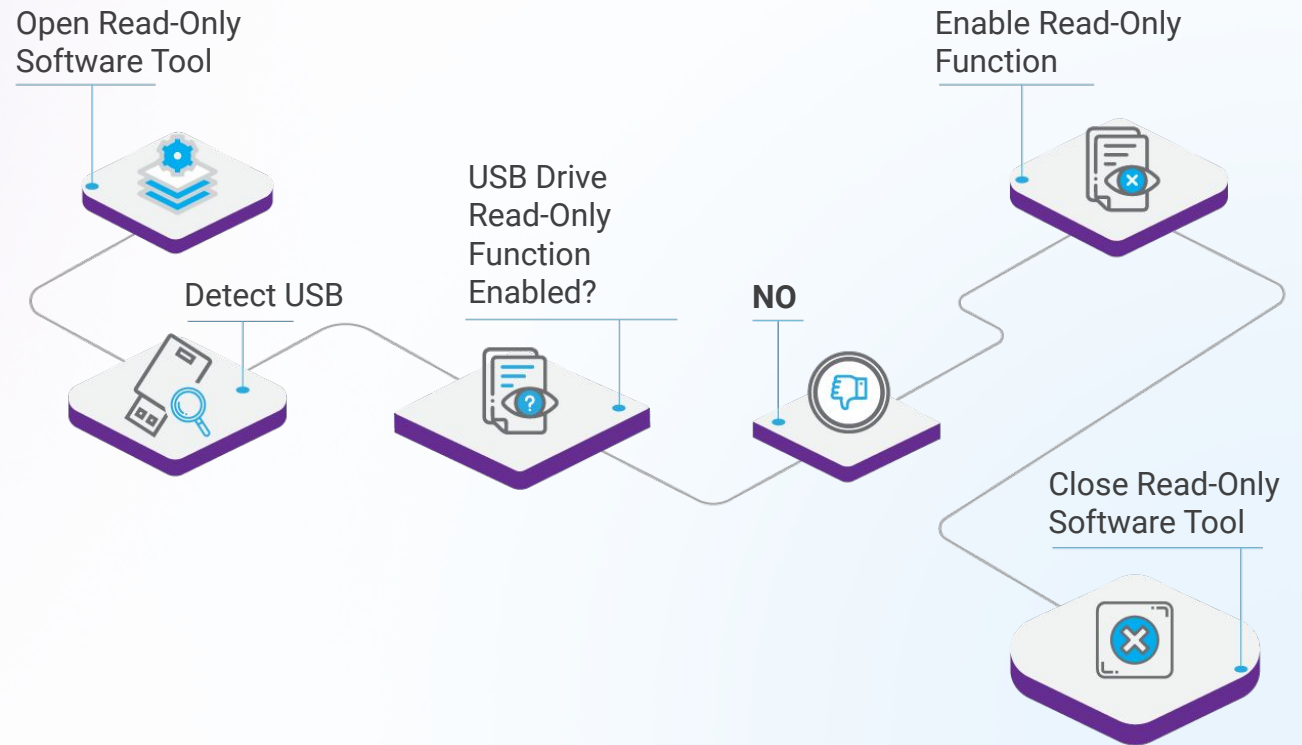

Step 3:

Disable the Read-Only Function

To change the data, disable the Read-Only Mode from the software first, make certain edits, and enable to keep data security intact.

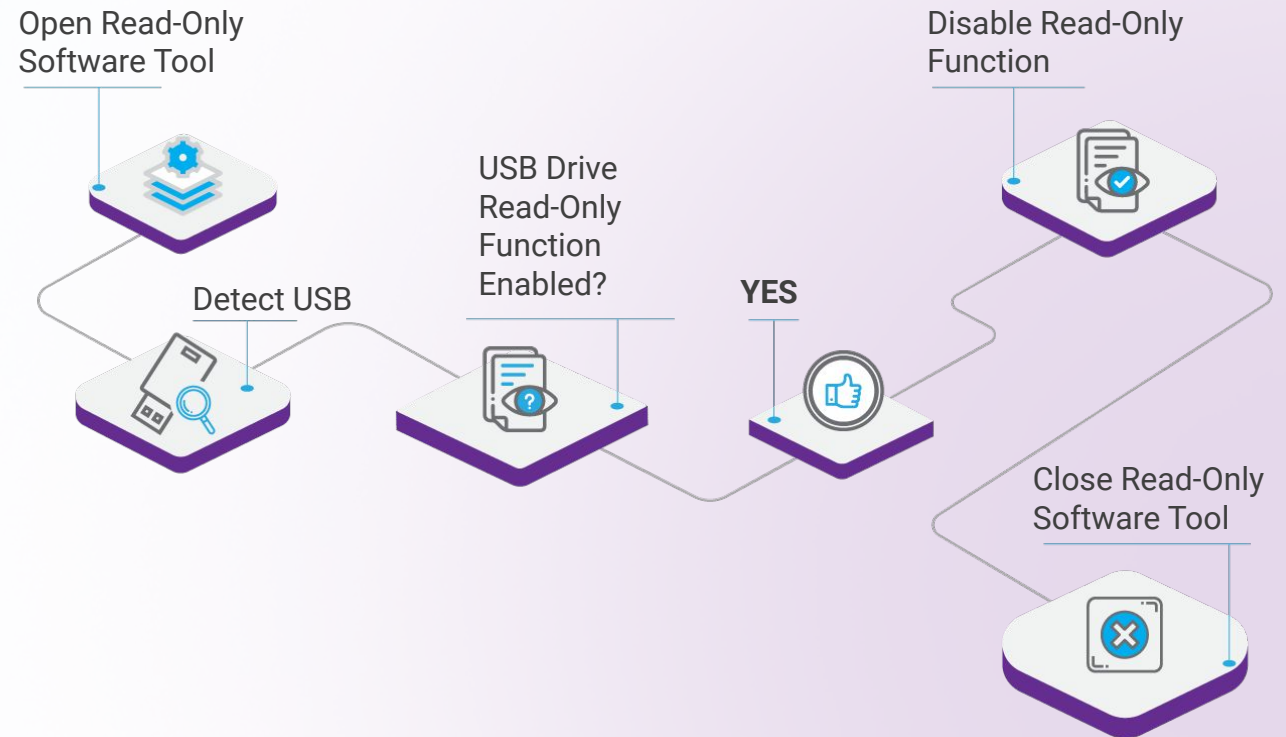

Step 1: Launch Flexxon Tool

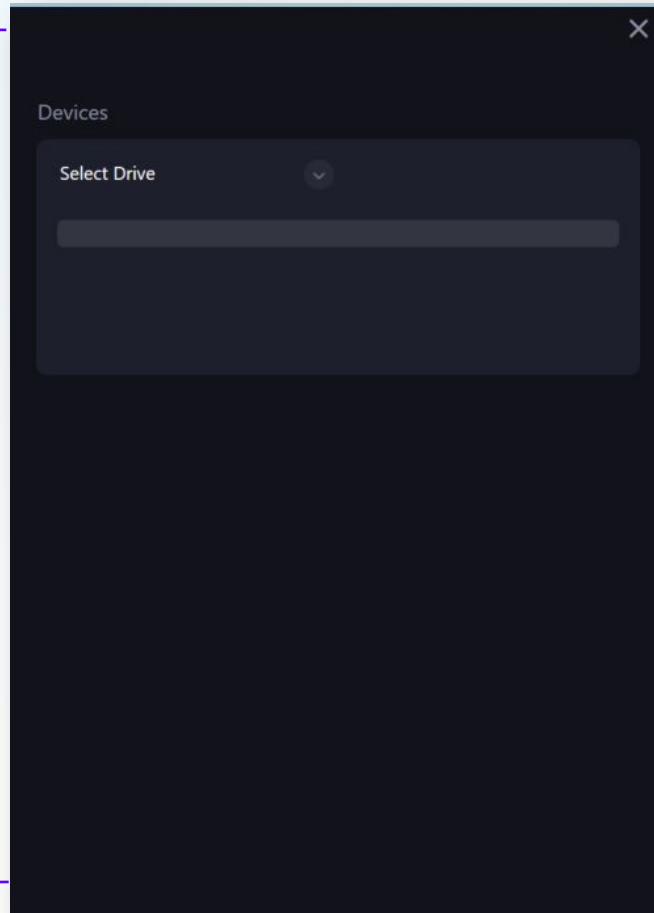

Step 2: Upon inserting the ROM USB Pen Drive, the ROM Tool will automatically recognize the connected drive.

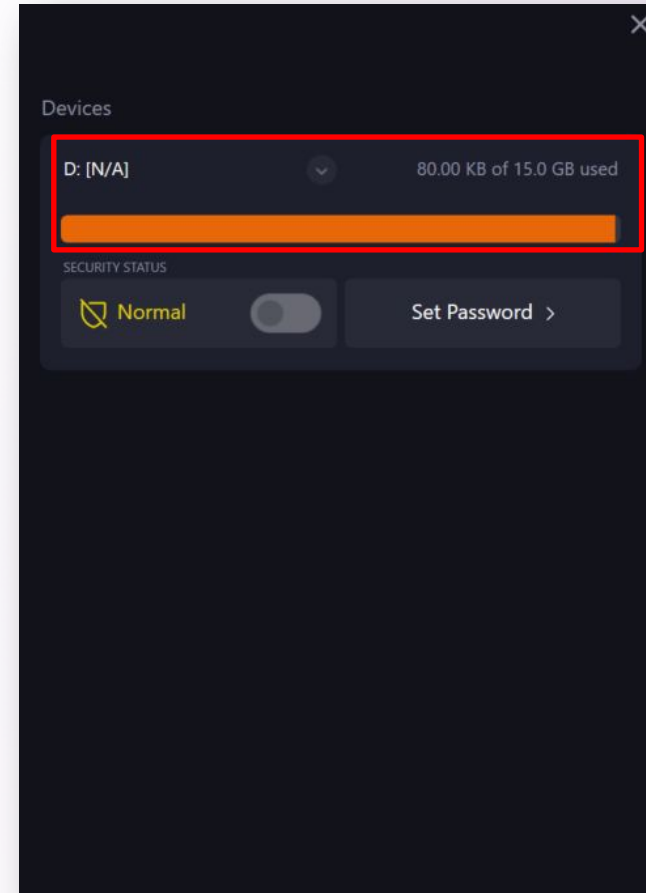

Step 3:

When the ROM Windows Tool displays the '**Normal**' status, it indicates that no password has been set for ROM USB Pen Drive.

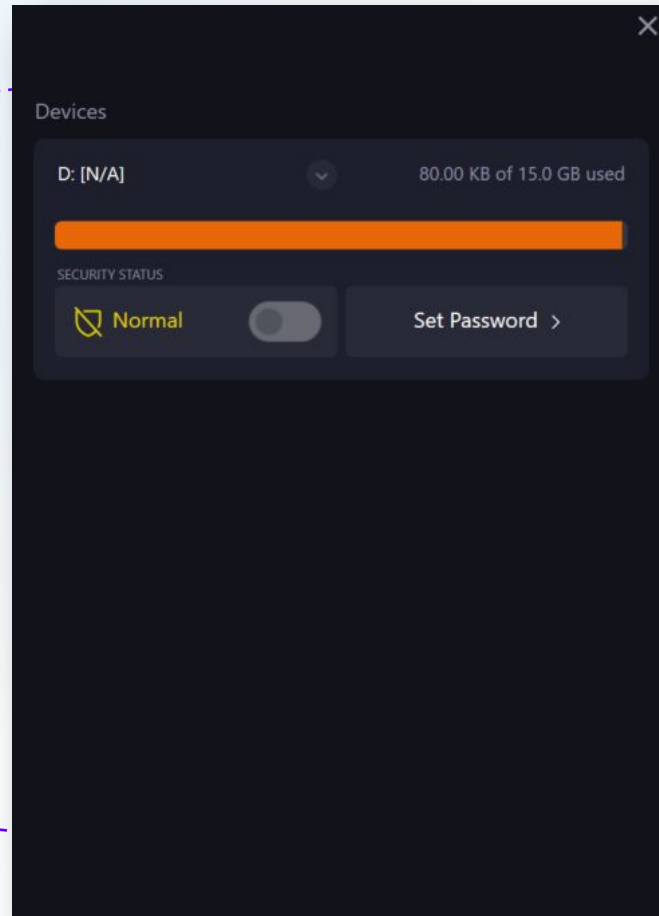

Step 4:

To set a password, click on "**Set Password**" and enter your chosen password.

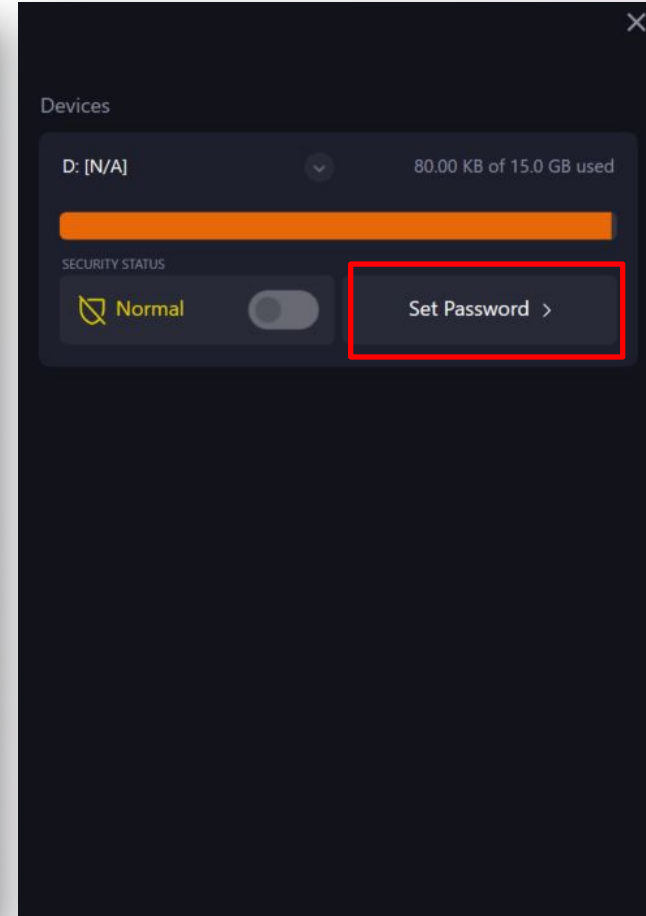

Step 5: Once you have successfully configured the drive, disconnect and then reconnect the ROM USB Pen Drive.

Step 6: After reinserting the drive, the read only mode is activated. All the stored data enables access for reading only. None can change, delete, or overwrite anything from the stored data. So, you can preserve the authenticity of the essential files into the ROM USB Pen Drive and prohibit it from the risk of alteration.

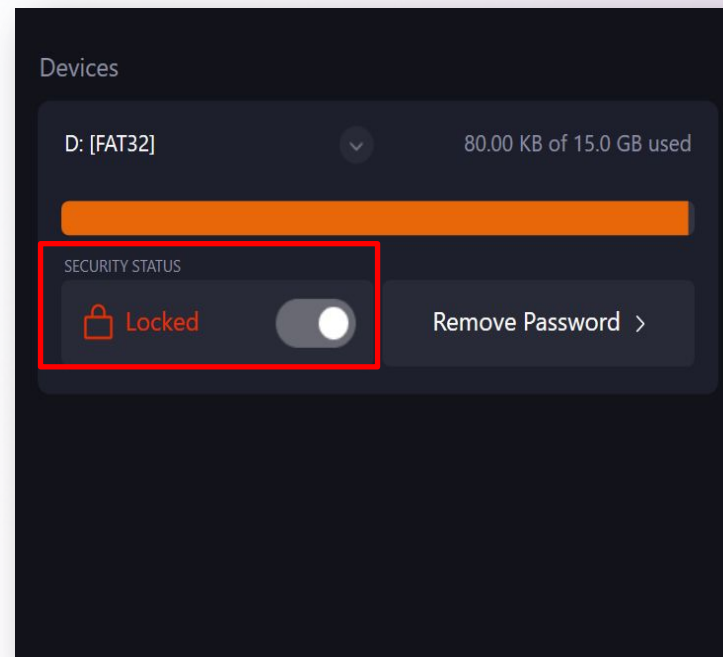
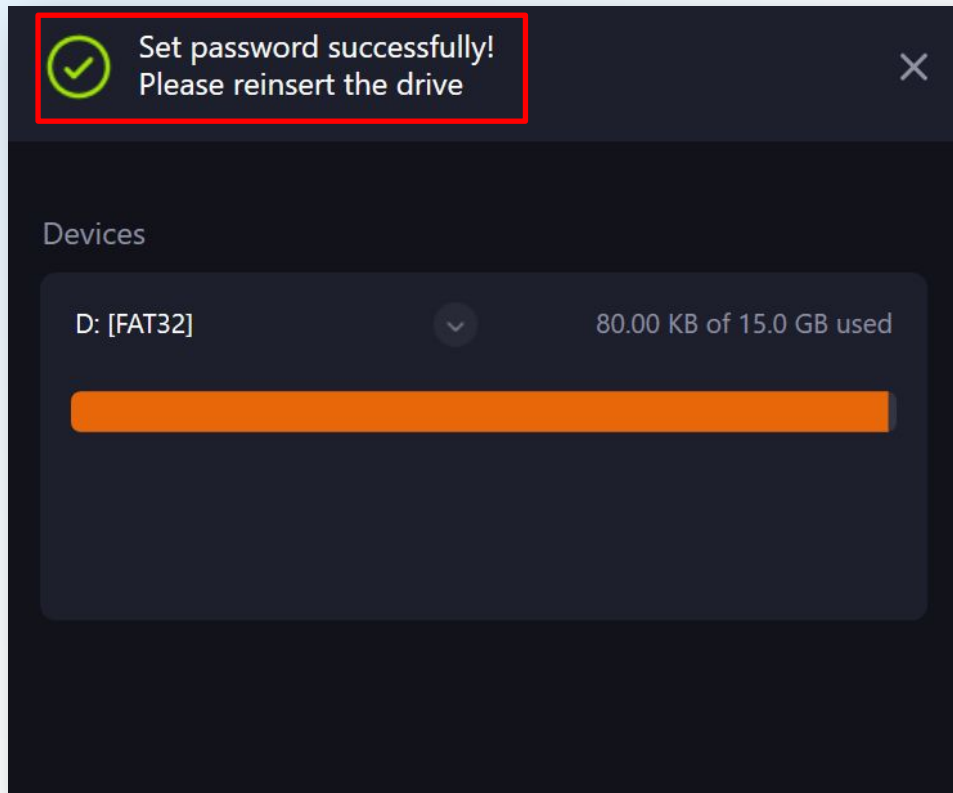

Note: User is required to eject and insert ROM USB Pen Drive to verify the content in ROM Drive.

The drive is in 'ROM' status, and the ROM Tool shows 'Locked'.

Step 7:

Functionality for 'Locked' button

The administrator can use the Flexxon ROM Tool and the **Correct Password** to temporarily modify data. However, once the USB Pen drive is disconnected from the host, it retains the ROM state.

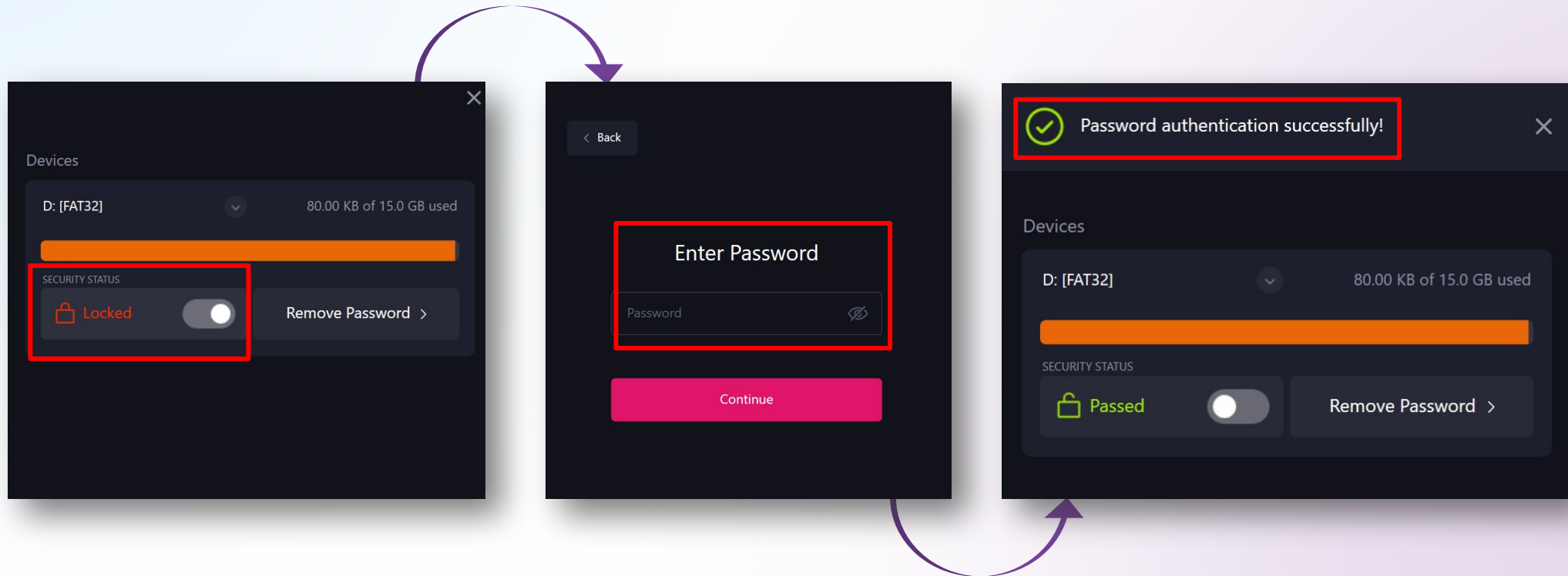

Note: The ROM USB Pen Drive will return to Read Mode after reinsert the drive.

To Remove Masking Feature

Select "**Remove Password**" and enter the **correct password**. Once the password is removed, a prompt will indicate "**Normal Status and No Password Exist.**" The ROM USB Pen drive will then operate like a standard USB Pen Drive without the Read-Only feature.

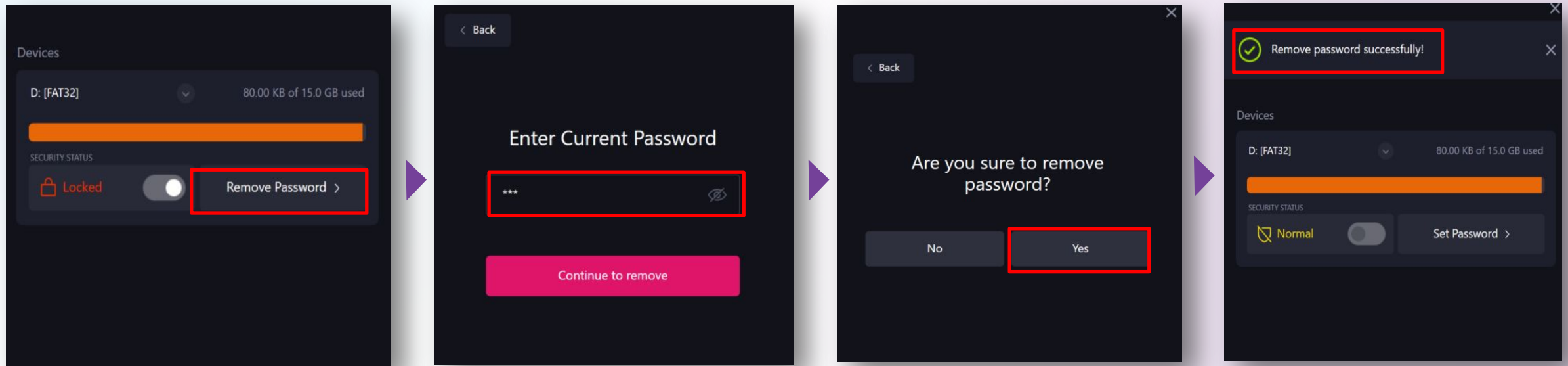

Applications | ROM USB Drive

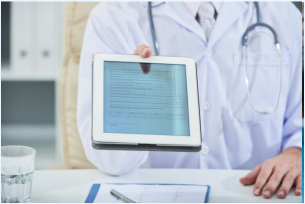

Medical And Healthcare Facilities

Keep the sensitive patient reports maintaining confidentiality and integrity.



Financial Institutes

Secure influential financial records and refrain from a financial data breach.



Business Organizations

Keep important business documents in an unalterable memory solution.



Cybersecurity Industry

Protect all the information in the electronic system from threats of illegal activities.



Read Only Mode (ROM) SSD Drive

Preserve the essential data From prohibited alterations

Ensure a tamper-proof data storage solution by making it unalterable to keep the crucial files safe with Flexxon Read Only SSD. Once you activate the Read Only mode into the SSD, all the stored data enables access for reading only and none can change, delete, or overwrite anything. Preserve the authenticity of essential files and prohibit the risk of alteration with the Read Only SSD.



Introduction

- ❖ This document is to provide an introduction of Flexxon Read Only SSD.
- ❖ To provide an overview of the product and features.
- ❖ When the Read Only feature is enabled, the data stored on the SSD is locked in a Read Only mode. This means no data can be altered, deleted, or overwritten under any circumstances.
- ❖ When Read Only function is disabled, SSD can do data read and write again.





Secured Data

- ❖ Read-only Mode
- ❖ Prohibit data from the risk of alteration.



Security Mechanism

- ❖ Use security tool (Windows base) to activate and deactivate read only mode.



- ❖ Interface: SATA III
- ❖ Form factor / Capacity:
 - 2.5" : 64GB – 1TB
 - Half Slim: 64GB – 1TB
 - M.2 2280: 64GB – 512GB
 - mSATA: 64GB – 512GB
- ❖ Support SMART and TRIM commands
- ❖ Support Advance LDPC
- ❖ Global wear levelling
- ❖ Support Bad Block Management
- ❖ Support AES256
- ❖ Temperature Range
 - Operation (Commercial): 0C ~ 70C
 - Operation (Diamond): -40C ~ 85C
 - Storage: -45C ~ 85C



- ❖ The authentication process is easy to set up the Flexxon ROM SSD.
- ❖ A Windows tool to activate Read-Only mode and protect sensitive data on the SSD from unauthorized access.
- ❖ 3 Steps is required to use the ROM SSD.

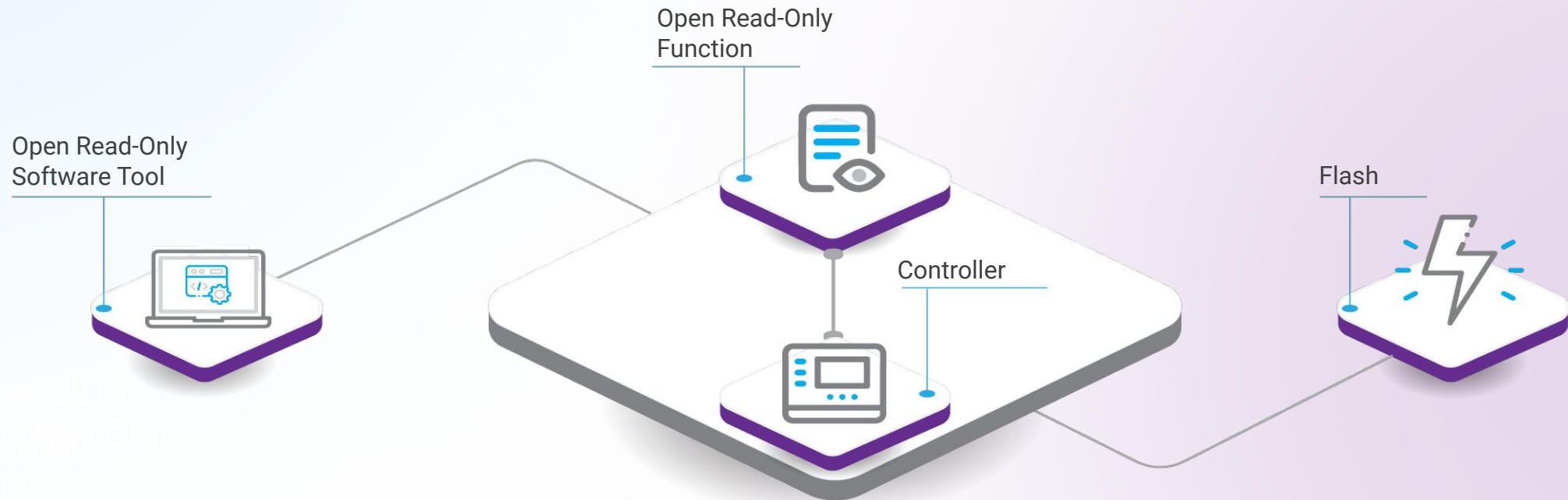

Date : 17 Jan, 2019
D:Reson By 2019 China
Present By: Mr. [Name]

Enable Read Only Function

Step 1:

Launch the software tool to activate or deactivate the Read-Only function

Step 2:

Enable the Read-Only Function
Enable the Read-Only Mode from the software following the chart step by step.

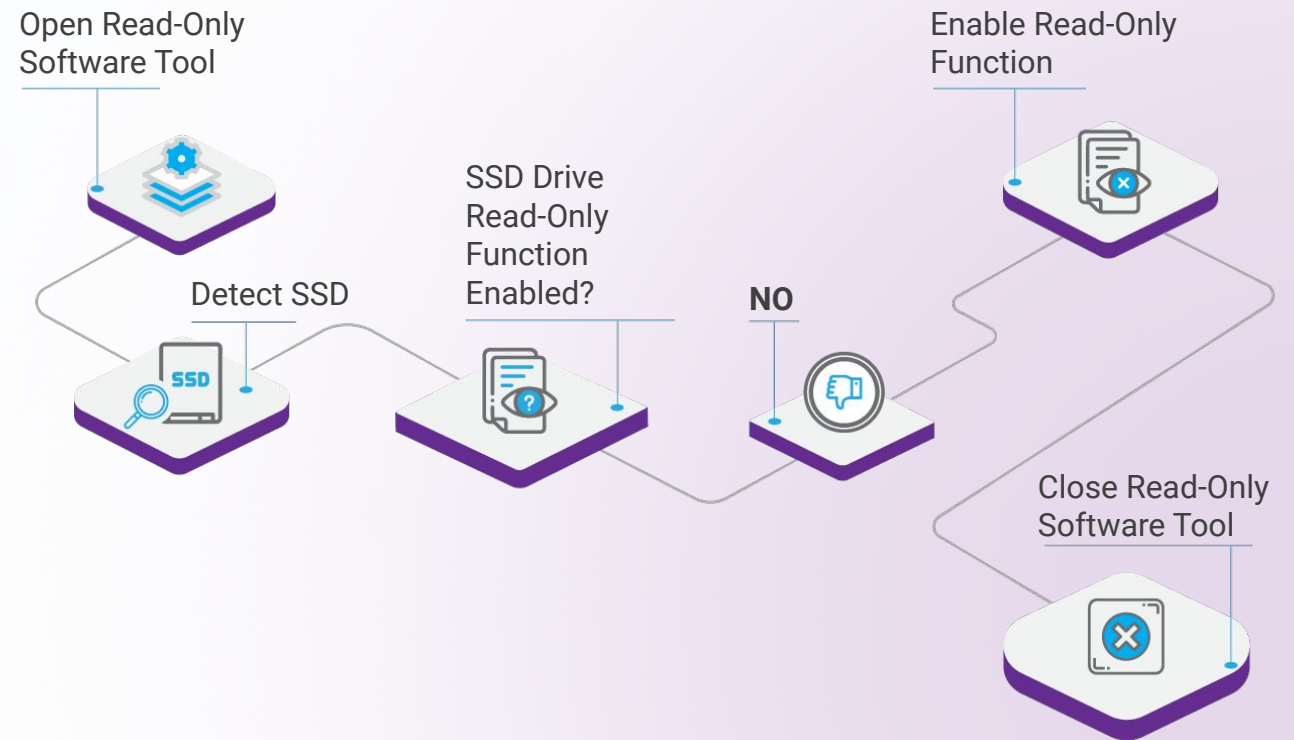

Step 3:

Disable the Read-Only Function To change the data, disable the Read-Only Mode from the software first, make certain edits, and enable to keep data security intact.

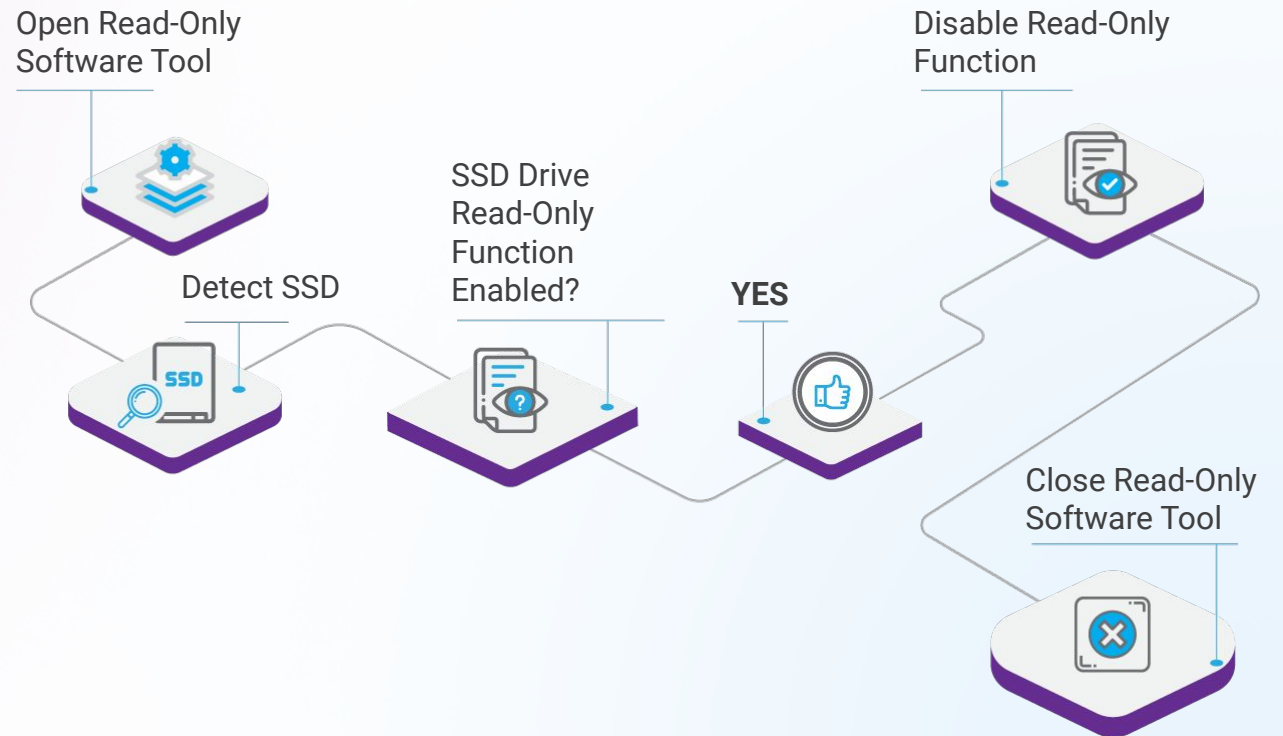

Step 1:



Connect FLEXXON Read Only SSD to Windows base PC.

Step 2:

Open the SSD Read Only Tool V1.4 folder by double click on it.

There are 3 (three) files contained in the folder:

 SSD_ReadOnlyTool V1.4

Config	 config
Read Only Tool v1.4	 ReadOnlyToolv1.4
Write Protected SDK_SSD_Win32.dll	 WriteProtectedSDK_SSD_Win32.dll

Step 3

Select "ReadOnlyToolv1.4" and double click to run it.

 config

 **ReadOnlyToolv1.4**

Step 3.

 WriteProtectedSDK_SSD_Win32.dll

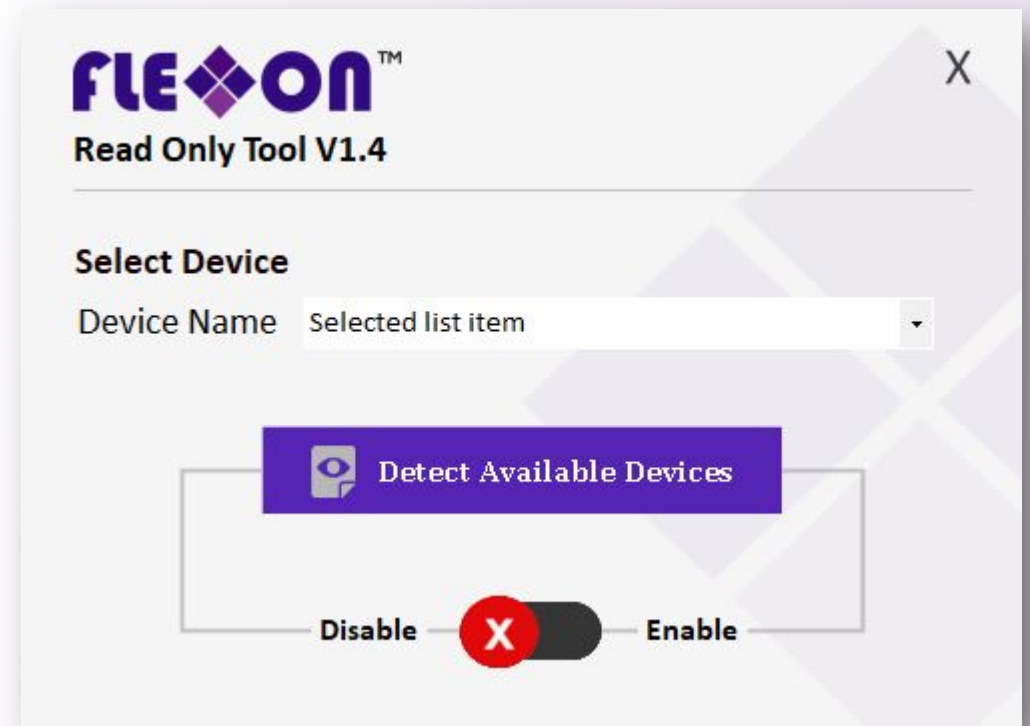

Step 4

An application windows will pop-out.

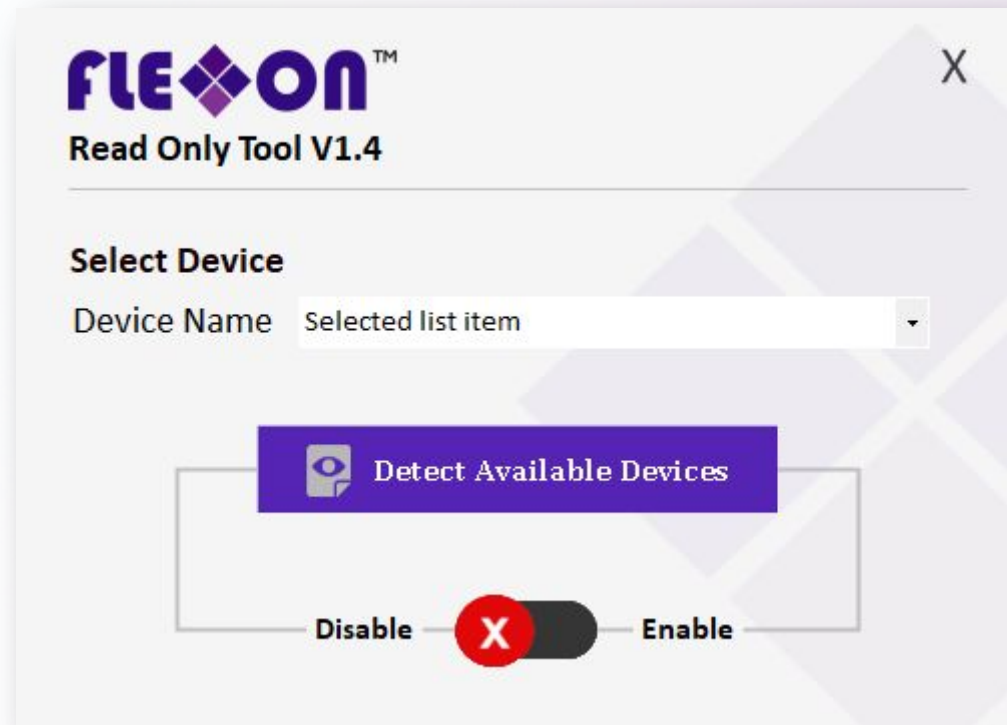

Step 5

Click on “**Detect Available Devices**”-5(a) , the SSD with Read Only feature is shown under “**Device Name**” - 5(b) and the “**Read Only Mode Status**” - 5(c) will show the SSD is in “**Read Only Mode**” disabled or enabled.



Step 6

Read Only Mode can be **Enable** / **Disable** by clicking the button.

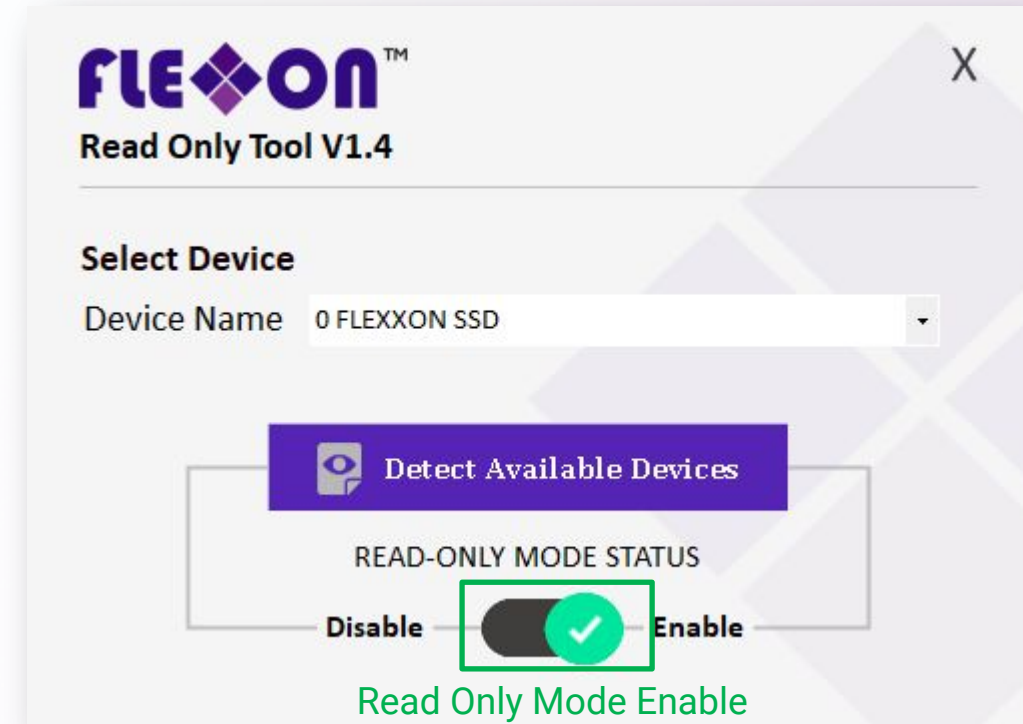

Step 7

Power off and power on again the SSD in order to let modified setting take into place.

Applications | ROM SSD Drive



Medical And Healthcare Facilities

Keep the sensitive patient reports maintaining confidentiality and integrity.



Financial Institutes

Secure influential financial records and refrain from a financial data breach.



Business Organizations

Keep important business documents in an unalterable memory solution.



Legal & Educational

Protect all the information in the electronic system from threats of illegal activities.



Why Flexxon?

Long Product
Life

Fixed BOM

Industrial Grade

Special Capacity
& Customize
Memory Solution

Strong Technical
Support

Support
HMLV(High-Mixed
Low Volume)

Contact Us

Flexxon Pte. Ltd.

28 Genting Lane, #09-03/04/05
Platinum 28, Singapore 349585

Tel : +65-6493 5035

Fax : +65-6493 5037

www.flexxon.com
flexxon@flexxon.com